

GEMINI LIFT AND TURN COMPRESSION LATCHES

- 316 Stainless Steel*
- Superior GEMLUX finish
- Single, Round Hole Installation
- 2" and 2.5" Latches available in both
- Locking and Non-Locking versions

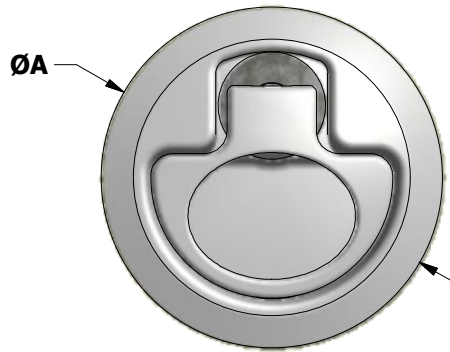

NON-LOCKING



LOCKING

(For locking latch change the sixth digit in the part number to a **3**. Ex: 4024-1311)

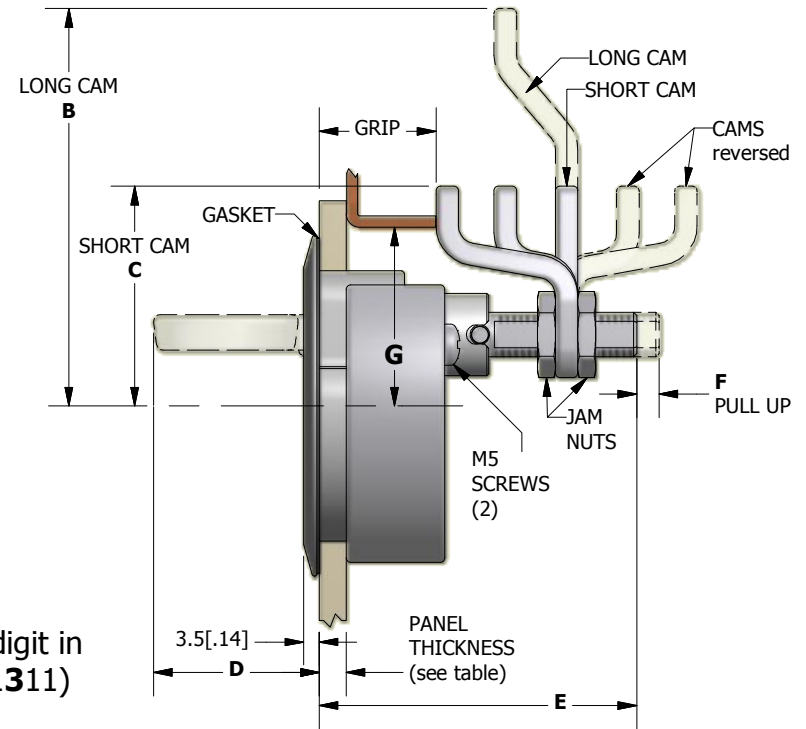

Series	Hole ϕ	Door Thickness X	Grip Range				Part Number		A	B	C	D	E	F	
			Cam Forward		Cam Reversed		Short Cam	Long Cam							
			MIN	MAX	MIN	MAX									
4024	50 (2.0)	2 (.075) to 12 (.475)	[X+19]	[X+19] 28(1.10)	63(2.48)	76(3.00)	4024-1111	4024-1114	61.5 (2.41)	70 (2.75)	56.5 (2.23)	30 (1.18)	61.5 (2.42)	4 (.16)	
			[X+19]	27(1.06)	40(1.57)	51(2.01)	64(2.52)	4024-1112							4024-1115
			39(1.53)	52(2.04)	-	-	4024-1113	4024-1116							
		12 (.475) to 22.5 (.885)	[X+9]	[X+9] 28(1.10)	63(2.48)	76(3.00)	4024-1121	4024-1124							
			[X+19]	27(1.06)	40(1.57)	51(2.01)	64(2.52)	4024-1122							4024-1125
			39(1.53)	52(2.04)	-	-	4024-1123	4024-1126							
4030	63.5 (2.5)	2 (.075) to 12 (.475)	[X+18]	35(1.38)	74(2.91)	88(3.47)	4030-1111	4030-1114	76 (3.0)	89 (3.5)	49.5 (1.95)	37 (1.46)	71 (2.80)	5 (.2)	
			34(1.34)	48(1.89)	60(2.36)	75(2.95)	4030-1112	4030-1115							
			47(1.85)	61(2.40)	-	-	4030-1113	4030-1116							
		12 (.475) to 22.5 (.885)	[X+8]	35(1.38)	74(2.91)	88(3.47)	4030-1121	4030-1124							
			34(1.34)	48(1.89)	60(2.36)	75(2.95)	4030-1122	4030-1125							
			47(1.85)	61(2.40)	-	-	4030-1123	4030-1126							

All dimensions in millimeters(Inches)

*Some components made of 304 stainless steel and nylon