

## 90° CONNECTOR

Designed and made in New Zealand, TruDesign Connectors are the superior composite connection for linking 2 hoses. The 90° Connector is especially useful for eliminating large radius bends involved in plumbing with stiff hose. This allows hoses to be securely routed next to bulkheads and walls.



TruDesign Connectors are moulded from a glass reinforced nylon composite. High strength, high-modulus glass fibres impregnated into the nylon provides dramatic strength, stiffness, toughness, and dimensional stability. TruDesign Connectors eliminate the corrosion and electrical bonding problems associated with metallic fittings. The Connectors are designed for twin hose clamps, and to not crush under high load conditions.

### KEY FEATURES

Feature :	
Manufactured from a glass reinforced nylon composite	High strength and light weight.
Compatible with all hull types	Can be used on aluminum, steel, wood or FRP hulls.
Immune to corrosion and electrolysis	Long life with no concerns over decreased performance due to corrosion.
Chemical resistant	Impervious to diesel, petrol and antifouling paints.
UV resistant	These fittings will not break down with ultraviolet light or discolour from the sun.
High quality surface finish	Will not discolour with green film as similar bronze fittings do.
Large operating temperature range	Suitable for all marine environments, from -40°C to +110°C.

## Part Numbers

Part # Black	Part # White	
		TAIL TO TAIL 90° CONNECTORS
90699	90701	Connector 90° 19mm
90700	90702	Connector 90° 19mm PKG
90494	90493	Connector 90° 25mm
90608	90605	Connector 90° 25mm PKG
90291	90292	Connector 90° 38mm
90609	90606	Connector 90° 38mm PKG
90496	90495	Connector 90° 50mm
90610	90607	Connector 90° 50mm PKG

## Dimensions

<b>A</b>		<b>B</b>		<b>C</b>		<b>D</b>	
Tail Size		Tail Length		Length		Minimum Internal $\varnothing$	
19mm	¾"	30mm	1 1/6"	52mm	2"	13mm	1/2"
25mm	1"	40mm	1 4/7"	65mm	2 5/9"	19mm	3/4"
38mm	1½"	40mm	1 4/7"	73mm	2 7/8"	31mm	1 2/9"
50mm	2"	40mm	1 4/7"	73mm	2 7/8"	43mm	1 2/3"

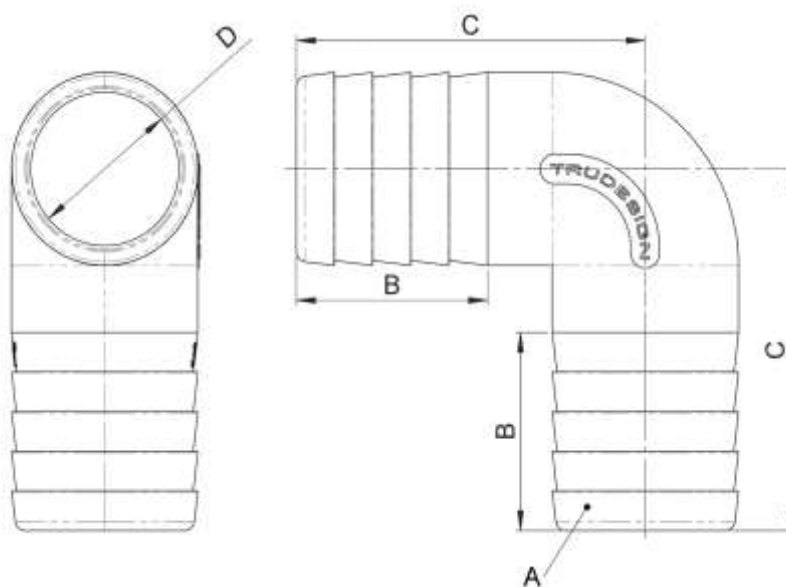

The information contained in this information sheet is for general information purposes only. The information is provided by TruDesign™ and while we endeavour to keep the information up to date and correct, we make no representations or warranties of any kind, express or implied, about the completeness, accuracy, reliability, suitability or availability. Any reliance you place on such